



WASHINGTON COUNTY
 Dept. of Land Use & Transportation
 Land Development Services Division
 155 N. 1st Avenue, #350-13
 Hillsboro, OR 97124
 Ph. (503) 846-8761 Fax (503) 846-2908
 http://www.co.washington.or.us

Measure 37 Public Notice

RURAL **CPO: 15**
RURAL/NATURAL RESOURCE PLAN ELEMENT
EXISTING LAND USE DISTRICT(S):
 AF20 District (Agriculture and Forestry)
APPLICABLE LAND USE DIST. FOR CLAIM:
 F-1
ASSESSOR MAP: TAX LOT NUMBER(S):
 1S3 25 00 00500, 00501, 00502, 00503, 00504

CLAIM NO.: 37CL0766

CLAIMANT & OWNER:
 Lorelei A. Lewis
 31681 SW Riedweg Road
 Cornelius, OR 97113

CLAIMANT'S REPRESENTATIVE:
 Draneas & Huglin, P.C.
 Mark L. Huglin
 4004 SW Kruse Way Pl, Ste 200
 Lake Oswego, OR 97035

DATE PROPERTY ACQUIRED: 12/28/1973

PROPERTY DESCRIPTION:
SITE SIZE: 42.57 acres
SITE ADDRESS: 31681 Sw Riedweg Road.
LOCATION: On the north and west side of SW Riedweg Road approximately 1600 feet south of its intersection with SW Simpson Road.

The decision to remove, modify or not apply a regulation is based on the owner's description of possible future development. The description of the development is required only for the purposes of determining which regulations allegedly restrict the use of the property & reduce its fair market value.

REGULATION TO BE REMOVED, MODIFIED OR NOT APPLIED: 2006 CDC Sections 344 (Agriculture and Forest), 430-85 (Nonfarm Dwellings), 430-37.2 A., B.(Farm Dwellings), and 610-1 (Property Line Adjustment), based on the claimant's desire to divide TL 500 into 2 lots; divide TL 501 into 2 lots; divide TL 502 into 3 lots; divide TL 503 into 2 lots; divide TL 504 into 3 lots; and build a dwelling on each vacant lot.

ESTIMATED VALUE OF CLAIM: \$1,200,000

***Note: Most approved claims will require subsequent land use review prior to development approval. If a subsequent application is submitted and accepted, notice will be provided to surrounding property owners according to CDC 204.**

AREA MAP  **SUBJECT PROPERTY** →

The claimant is seeking Administrative Approval of the above-stated Measure 37 Claim.

The Director reserves the right to modify, not apply or remove one or more land use regulations to allow the owner to use the property for a use permitted at the time the owner acquired the property in lieu of compensation for the alleged loss of value.

This is an opportunity for interested persons to submit written comments about this Measure 37 Claim before the Director makes a decision on the request. In reviewing this request, the Director will consider all written comments actually received by the Department within 14 calendar days from the date this Notice is mailed.

(over)

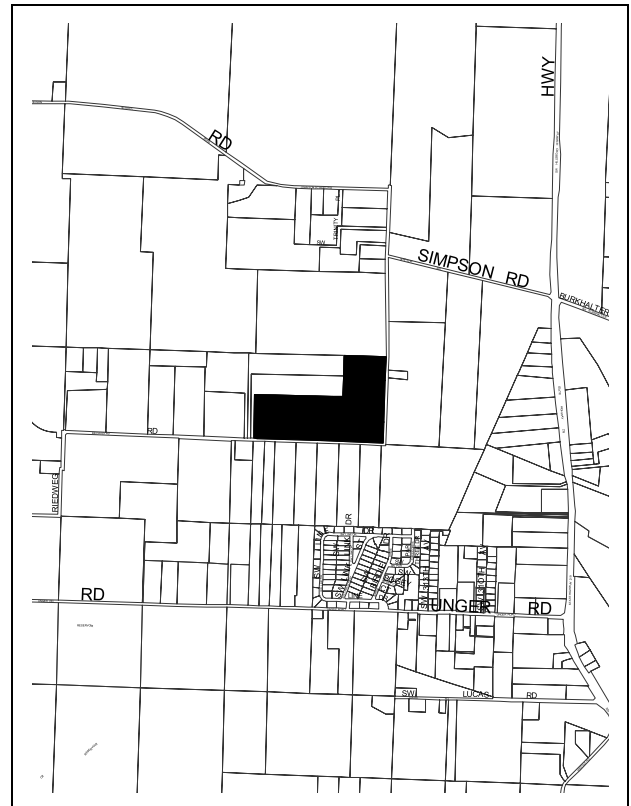

Minimum content for an eligible claim:

1. Date claimant acquired property.
2. The County land use regulation that restricts the use of the property.
3. Whether the land use regulation reduces the fair market value of the property.
4. Whether the County has enforced the land use regulation against the property or its owner.
5. The land use regulation is not exempt under terms of Measure 37.

The Notice of Decision for this Measure 37 Claim will be mailed to those persons entitled to receive a Notice of Decision pursuant to Ordinance Number 636. (Individuals who receive a copy of this Public Notice and other persons who submit written comments to the Department will receive a Notice of Decision.) The decision of the Director may be appealed to Washington County Circuit Court.

The complete application, code requirements and other information are available for review at the Department of Land Use and Transportation. A copy of this material will be provided at reasonable cost.

COMMENT PERIOD:

7/10/07 to **7/24/07**
mailed date closing date (5:00 p.m.)

For further information, please contact:

Tom Harry, Senior Planner

at The Department of Land Use and Transportation. Phone 503-846-8761.

PLEASE SEND ALL WRITTEN COMMENTS TO:

Measure 37 Claim – File #: 37CL0766

Washington County DLUT

155 N. 1st Avenue, #350-13

Hillsboro, OR 97124