



WASHINGTON COUNTY
 Dept. of Land Use & Transportation
 Land Development Services Division
 155 N. 1st Avenue, #350-13
 Hillsboro, OR 97124
 Ph. (503) 846-8761 Fax (503) 846-2908
 http://www.co.washington.or.us

Measure 37 Notice of Public Hearing

RURAL CPO: 8
 RURAL/NATURAL RESOURCE PLAN ELEMENT
 EXISTING LAND USE DISTRICT(S):
 EFC District (Exclusive Forest and Conservation)
 APPLICABLE LAND USE DIST. FOR CLAIM:
 Lot 100 = Not zoned at time of acquisition
 Lots 200 & 300 = F-1
 ASSESSOR MAP: TAX LOT NUMBER(S):
 2N3 11 00 00100 & 00200
 2N3 12 00 00300

CLAIM NO.: 37CL0700

CLAIMANT & OWNER:
 Jane Horning
 21277 NW Brunswick Canyon Road
 North Plains, OR 97133

CLAIMANT'S REPRESENTATIVE:
 Bob Horning
 21215 NW Brunswick Canyon Road
 North Plains, OR 97133

DATE PROPERTY ACQUIRED:
 Lot 100 = 9/21/1967; Lots 200 & 300 = 7/19/72

PROPERTY DESCRIPTION:
 SITE SIZE: 118.11 acres
 SITE ADDRESS: 21277 NW Brunswick Canyon Road.
 LOCATION: On both sides of NW Brunswick Canyon Road approximately 1/2 mile north of its intersection with NW Pumpkin Ridge Road

The decision to remove, modify or not apply a regulation is based on the owner's description of possible future development. The description of the development is required only for the purposes of determining which regulations allegedly restrict the use of the property & reduce its fair market value.

REGULATION TO BE REMOVED, MODIFIED OR NOT APPLIED: 2006 CDC Sections 413 (Parking) and 430-97 (Campgrounds), based on the claimant's desire to develop a private park and camp ground on the site. The claimant has previously obtained approval for Claims 37CL0176, 37CL0177, and 37CL0178 waiving the 2005 CDC Sections (1) 342-3.3.A, 342-4.2.A, and 342-6.1; (2) 422; (3) 423-6; (4) All subsections of 428-4 except for 428-4.1.A (5), 428-4.4.D, and 428-4.5; (5) All subsections of 430-25.2, including the prohibition on water and electric hookups in 430-25.2.D, but excepting the remainder of Section 430-25.2.D; and (6) 430-88. As a part of the development of the site the claimant has requested approval to not pave or gravel the large event parking areas and a decrease in the required setback for campsites.

ESTIMATED VALUE OF CLAIM: \$550,000

*Note: All approved claims will require subsequent land use review prior to development approval. If a subsequent application is submitted and accepted, notice will be provided to surrounding property owners according to CDC 204.

AREA MAP SUBJECT PROPERTY

Notice is hereby given that the Board of County Commissioners will review the request for the above-stated Measure 37 claim action at a public hearing on:

February 6th, 2007 at 10:00 a.m. or after

In the Auditorium on the first floor of the Washington County Public Services Building, 155 North First Avenue, Hillsboro, Oregon, 97124.

(over)

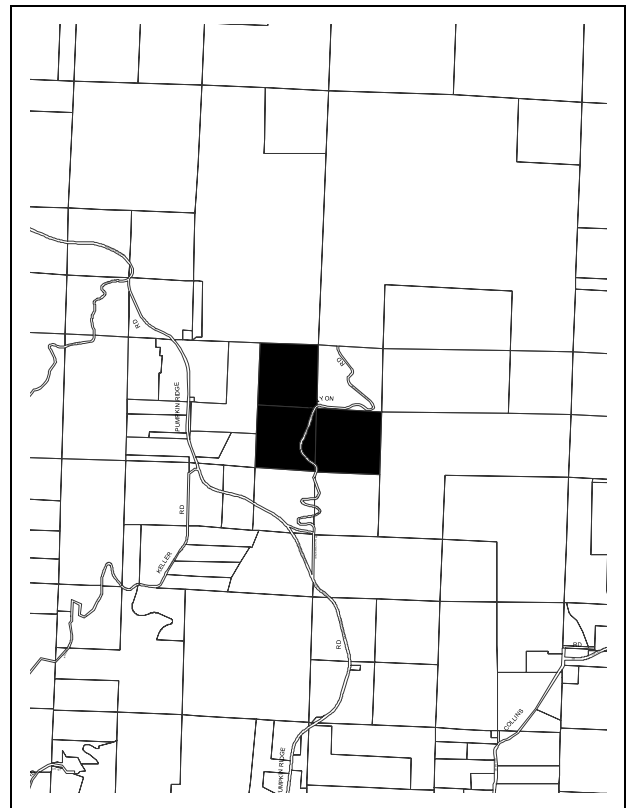

Minimum content for an eligible claim:

1. Date claimant acquired property.
2. The County land use regulation that restricts the use of the property.
3. Whether the land use regulation reduces the fair market value of the property.
4. Whether the County has enforced the land use regulation against the property or its owner.
5. The land use regulation is not exempt under terms of Measure 37.

Board Hearing Procedure:

- All interested persons may appear and provide written or oral testimony (written testimony may be submitted prior to the hearing but not after the conclusion of the hearing).
- Public testimony: Special rules regarding testimony & time limits may be established by the Board at the start of the hearing.

The Board shall have authority to decide whether:

- The Director's determination that the claim meets the minimum content requirements, and is an eligible claim, is correct. This is a *de novo* determination;
- To approve compensation and, if so, how much to pay;
- To modify, not apply or remove one or more land use regulations to allow the owner to use the property for a use permitted at the time the owner acquired the property in lieu of compensation; or
- To approve a combination of the remedies set forth above.
- The Board is not limited to those regulations listed in the claim. The Board may impose any conditions of approval that it deems reasonable and appropriate to protect the public interest. (Ordinance Number 636 15.16.080)

Staff Report:

- A copy of the claim, all documents and evidence relied upon by the claimant and applicable criteria are available for inspection at no cost at the Department of Land Use and Transportation. A copy of this material will be provided at reasonable cost.
- A copy of the staff report will be available for inspection at no cost at the Department of Land Use and Transportation at least 7 (seven) days prior to the hearing. A copy of the Staff Report will be provided at reasonable cost.

For further information, please contact:

Tom Harry, Senior Planner

at The Department of Land Use and Transportation. Phone 503-846-8761.

PLEASE SEND ALL WRITTEN COMMENTS TO:

Measure 37 Claim – File #: 37CL0700

Washington County DLUT

155 N. 1st Avenue, #350-13

Hillsboro, OR 97124

Assistive Listening Devices

- Assistive Listening Devices are available for persons with impaired hearing and can be scheduled for this meeting by calling 503-846-8611 (voice) or 503-846-4598 (TDD – Telecommunications Devices for the Deaf) no later than 5:00 p.m., on the Monday preceding the meeting.

Sign Language and Interpreters

- The County will also upon request endeavor to arrange for the following services to be provided:
 1. Qualified sign language interpreters for persons with speech or hearing impairments; and
 2. Qualified bilingual interpreters.
- Since these services must be scheduled with outside service providers, it is important to allow as much lead-time as possible. Please notify the County of your need by 5:00 p.m. on the Thursday preceding the meeting date (same phone numbers as listed above: 503-846-8611 or 503-846-4598).