



## WASHINGTON COUNTY

Dept. of Land Use & Transportation  
Current Planning Services  
155 N. 1<sup>st</sup> Avenue, #350-13  
Hillsboro, OR 97124  
Ph. (503) 846-8761 Fax (503) 846-2908  
<http://www.co.washington.or.us>

## Political Signs



## POLITICAL SIGNS: WHERE, WHEN AND HOW

### 414 SIGNS

#### 414-5 Exemptions and Supplemental Criteria

The following signs are exempted from development permit requirement and from the standards set forth above.

##### 414-5.1 Temporary Signs:

The following temporary signs are permitted subject to the standards of Section 414-5.1F.:

- A. Construction Signs;
- B. Real Estate Signs;
- C. Temporary Land Development Project Signs pertaining to the sale, lease, rent or development of a subdivision, shopping center, industrial park or similar land parcel;
- D. Political campaign signs; and
- E. Farm or Forest product signs.
- F. Temporary signs listed in A through E above shall meet the following standards:
  - (1) Shall not exceed sixteen (16) square feet in area;
  - (2) Shall be located on private property, not within any dedicated right-of-way; and
  - (3) Shall be removed within fourteen (14) days after the election, sale, rental, lease or conclusion of event.

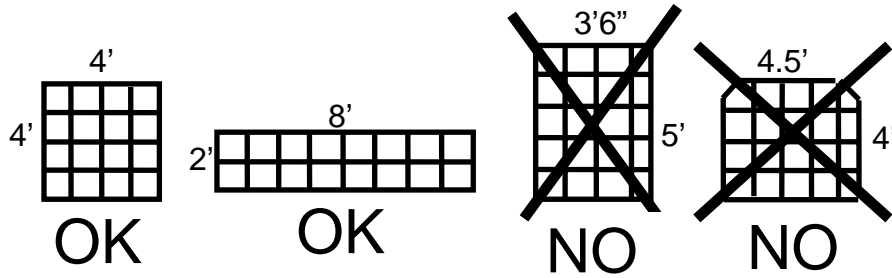

In the unincorporated portion of Washington County, temporary signs not exceeding sixteen square feet in area (e.g. no more than 4' x 4') may be placed on private property with the permission of the land-owner except within twenty feet in either direction of the street corner.

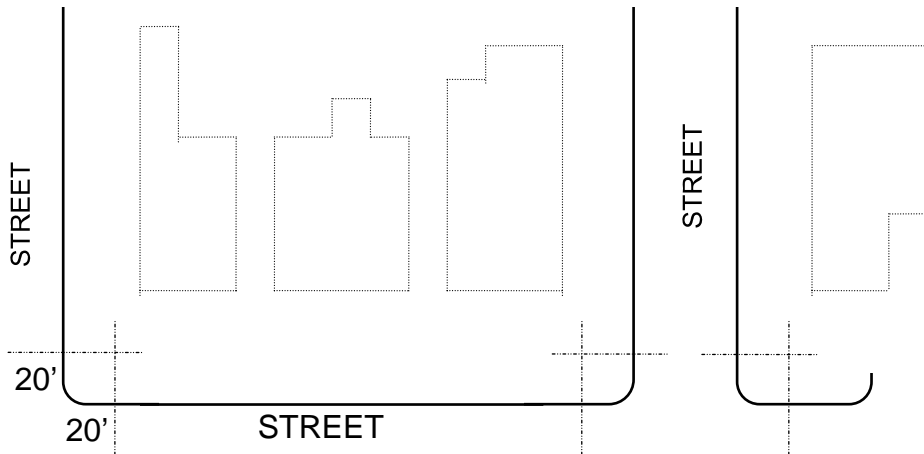

A Development Permit or Building Permit is not required to erect political campaign signs. NOTE: ALTHOUGH NO PERMITS ARE REQUIRED, ALL SIGNS MUST MEET THE COMMUNITY DEVELOPMENT CODE CRITERIA (SEE BACK PAGE).

Temporary signs may not be placed in the public right-of-way. As a general rule, signs should not be placed on any power poles, or in the area between the sidewalk and the curb.

Signs must be removed **within fourteen days after the election.**

If you have any questions, call the Washington County Dept. of Land Use and Transportation, Current Planning Services at (503) 846-8761.